



OPERATING CONDITIONS/ELECTRICAL CHARACTERISTICS

PARAMETERS	CONDITIONS	ECS-3963-BN (3.0V)			UNITS
		MIN	TYP	MAX	
Frequency Range		1.544		125.000	MHz
Frequency Stability				± 50	PPM
Operating Temperature		-40		+85	°C
Storage Temperature		-55		+125	°C
Input Voltage Vcc		+2.7	+3.0	+3.3	V DC
Input Current	1.544 MHz to 35.000 MHz			20	mA
	35.100 MHz to 50.000 MHz			35	mA
	50.100 MHz to 125.000 MHz			40	mA
Output Symmetry	at ½ Vcc level	40/60		60/40	%
	at ½ Vcc level (T Option)	45/55		55/45	%
Rise and fall Times	10% Vcc to 90% Vcc			5	ns
"0" Level				Vcc *0.1	Vdc
"1" Level		Vcc *0.9			Vdc
Output Load	HCMOS			15	pF
Start-Up Time				10	ms

PACKAGE DIMENSIONS (mm)

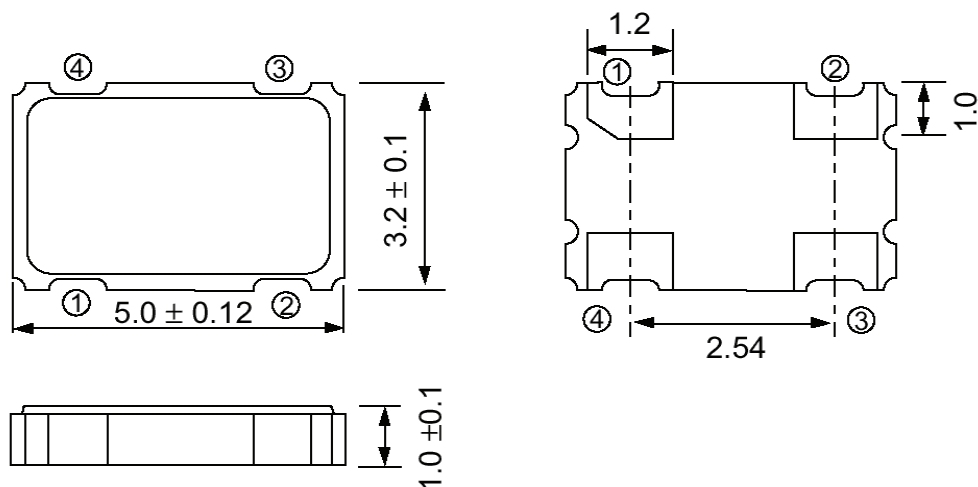

Figure 1) Top, Side and Bottom Views

Pin Connections	
1	Tri State
2	Gnd
3	Output
4	Vcc

Tri State Control Voltage	
Pin 1	Pin 3
Open	Output
+2.1 Min.	Output
0.75 Max..	No Oscillation

PART NUMBERING GUIDE: Example ECS - 3963 -160 - BN - TR

ECS - Series	Frequency Abbreviation -	Stability	Temp Range	Packaging
3963 +3V	160 = 16.000 MHz See P/N Guide	B=± 50 ppm	N=-40 ~ +85°C	TR=Tape & Reel